

The State of California or its officers or agents shall not be responsible for the accuracy or completeness of electronic copies of this plan sheet.

TYPICAL EXAMPLE

GIVEN :

Type A-2
Span length 46 ft
Sign 3 @ 50" depth
Post type 8 NPS t=1/2", "h" = 18 ft
Cross Beam type TS 6 x 4 x 1/4

1. Cross beam	1885
2. Post	2600
3. Sign mounting panel	204
Subtotal	4689
Add 3/2% for galvanizing (Sign structure - lightweight)	164
Total wt.	= 4853

PANEL DEPTH / PANEL LENGTH	40"	50"	60"	70"	80"	90"	100"
5'-14'	55	68	81	94	107	120	132
15'-24'	83	102	121	140	159	179	197

Weight in lbs, includes I-beams, U-bolts, channel, hanger plates and spacer brackets.

SIGN PANEL MOUNTING QUANTITIES

PANEL LENGTH	5'	6'	7'	8'	9'	10'	11'
WEIGHT	68	72	76	80	84	88	92

PANEL LENGTH	12'	13'	14'	15'	16'	17'	18'
WEIGHT	96	100	104	136	140	144	148

PANEL LENGTH	19'	20'	21'	22'	23'	24'
WEIGHT	152	156	160	164	168	172

Weight in lbs, includes extended part of channel angles and light fixture mounting channel

LIGHT FIXTURE MOUNTING ASSEMBLY
(Illuminated sign only)

THIS SHEET DOES NOT MEET 2001 AASHTO CODE

THIS SHEET NOT A PART OF CONTRACT PLANS

OVERHEAD SIGNS - LIGHTWEIGHT

QUANTITIES **21**

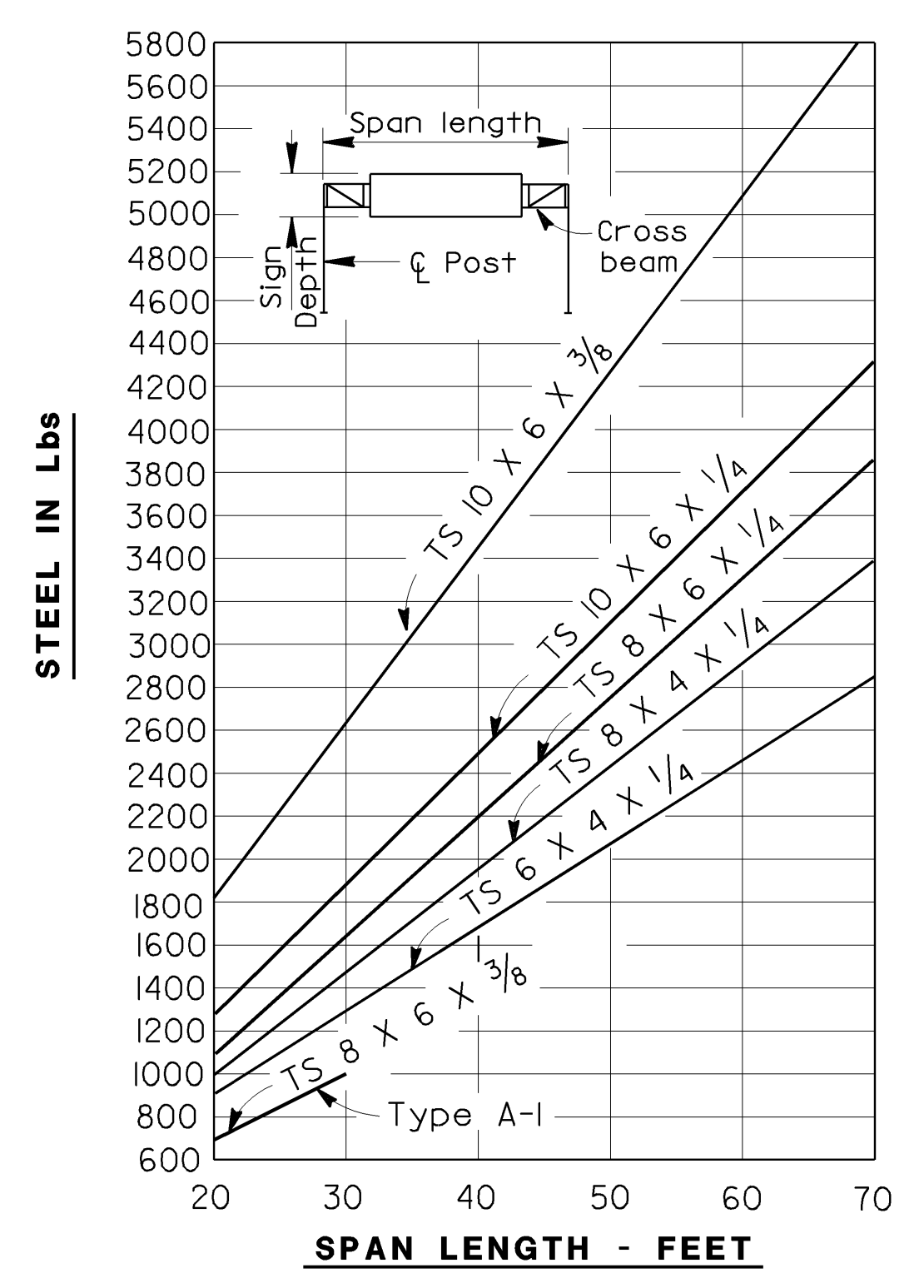

CROSS BEAM QUANTITIES - TYPE A

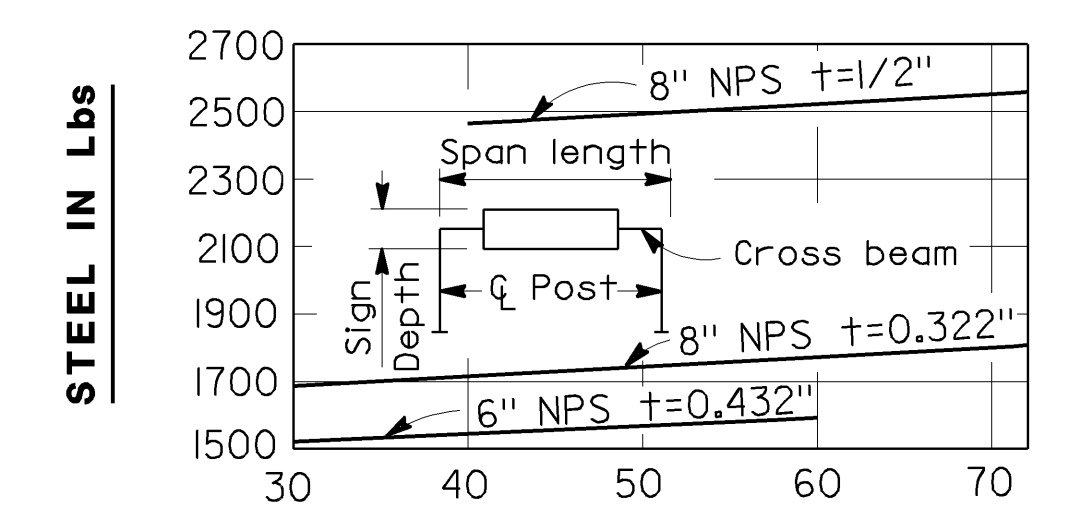

POST QUANTITIES, TOTAL 2, TYPE A-1

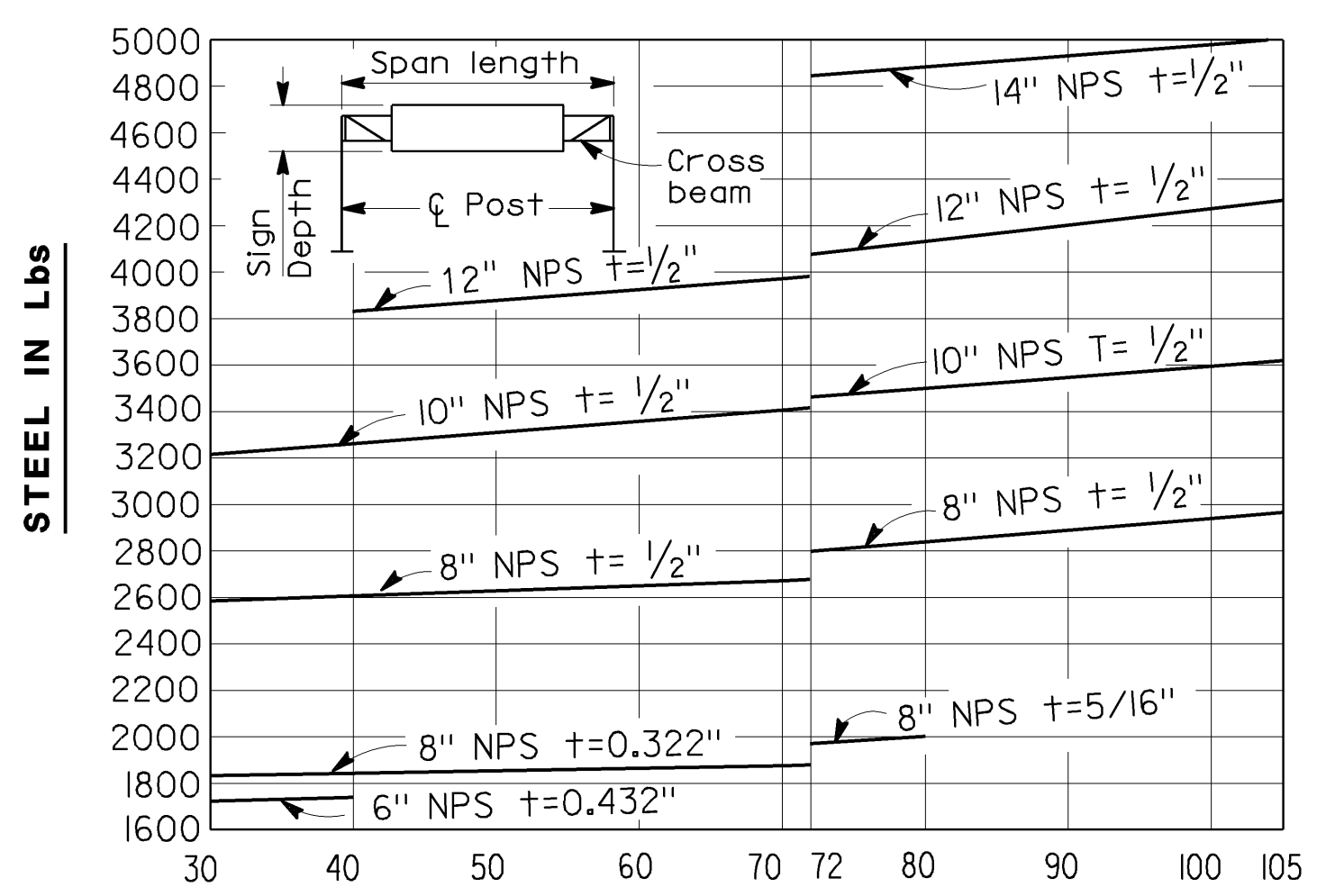

POST QUANTITIES, TOTAL 2, TYPE A-2

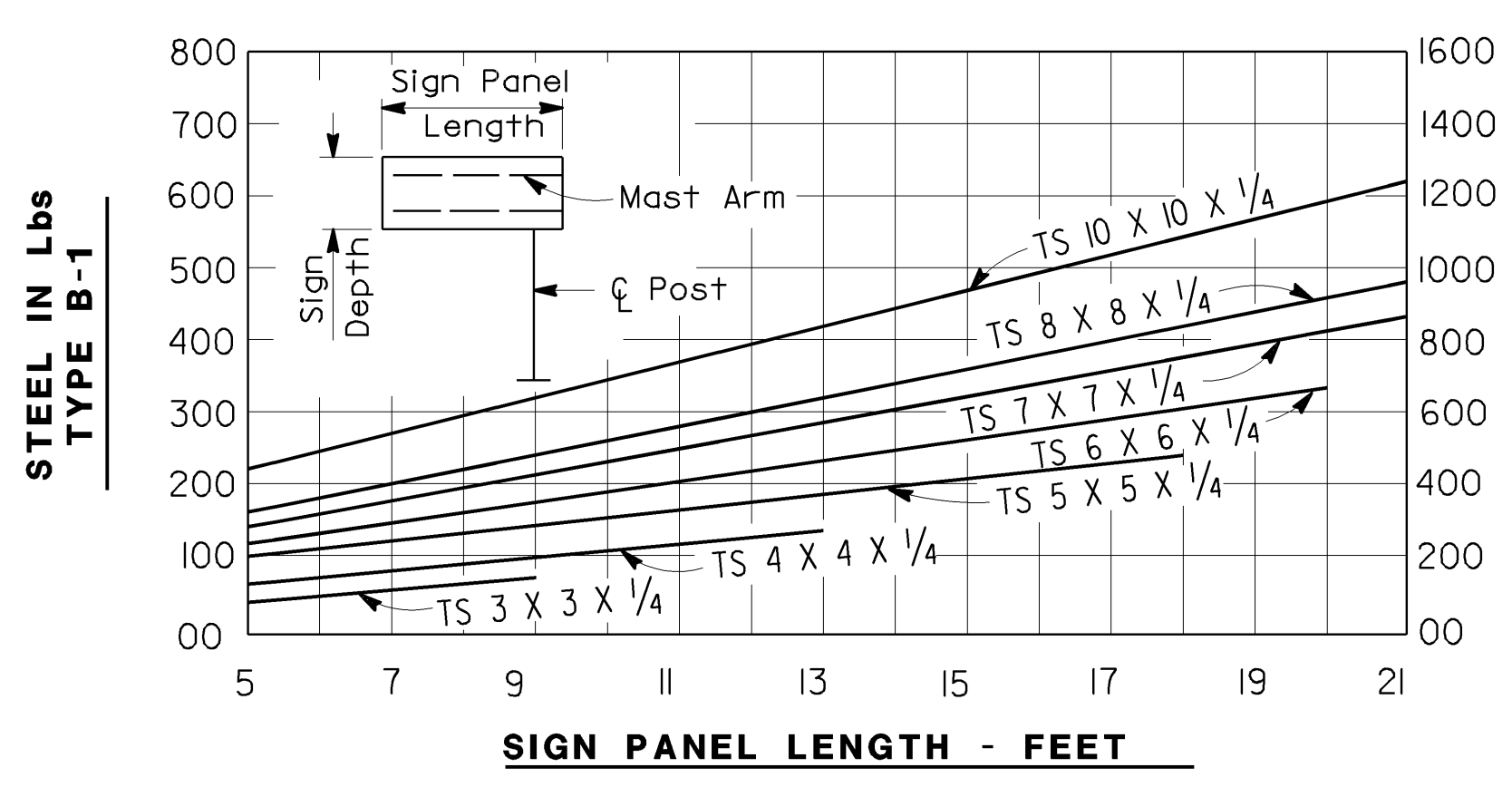

MAST ARM QUANTITIES - TYPE B

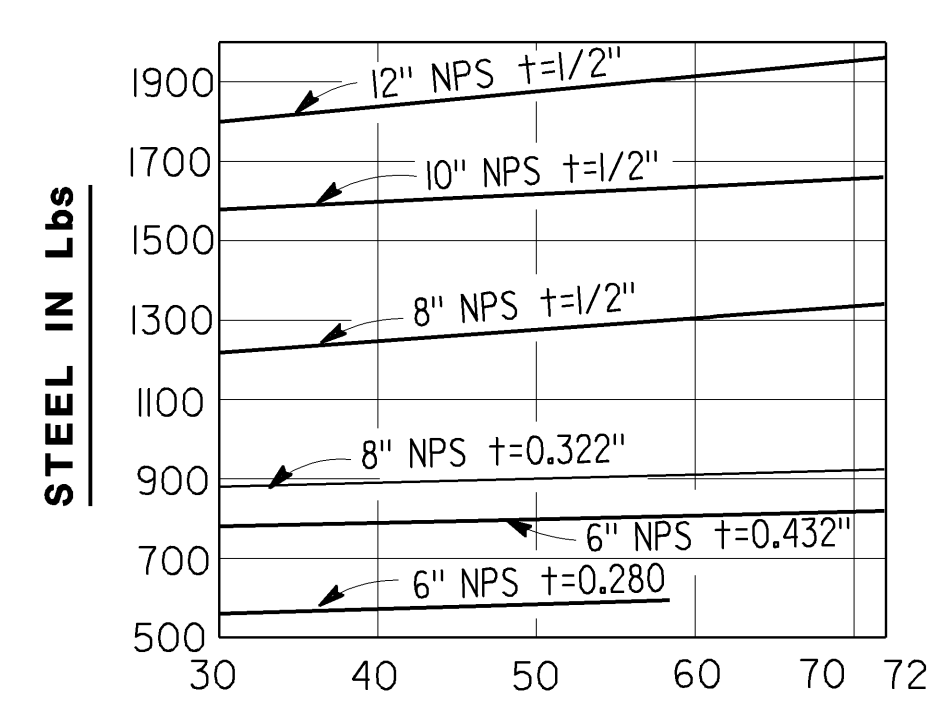

POST QUANTITIES - TYPE B-1

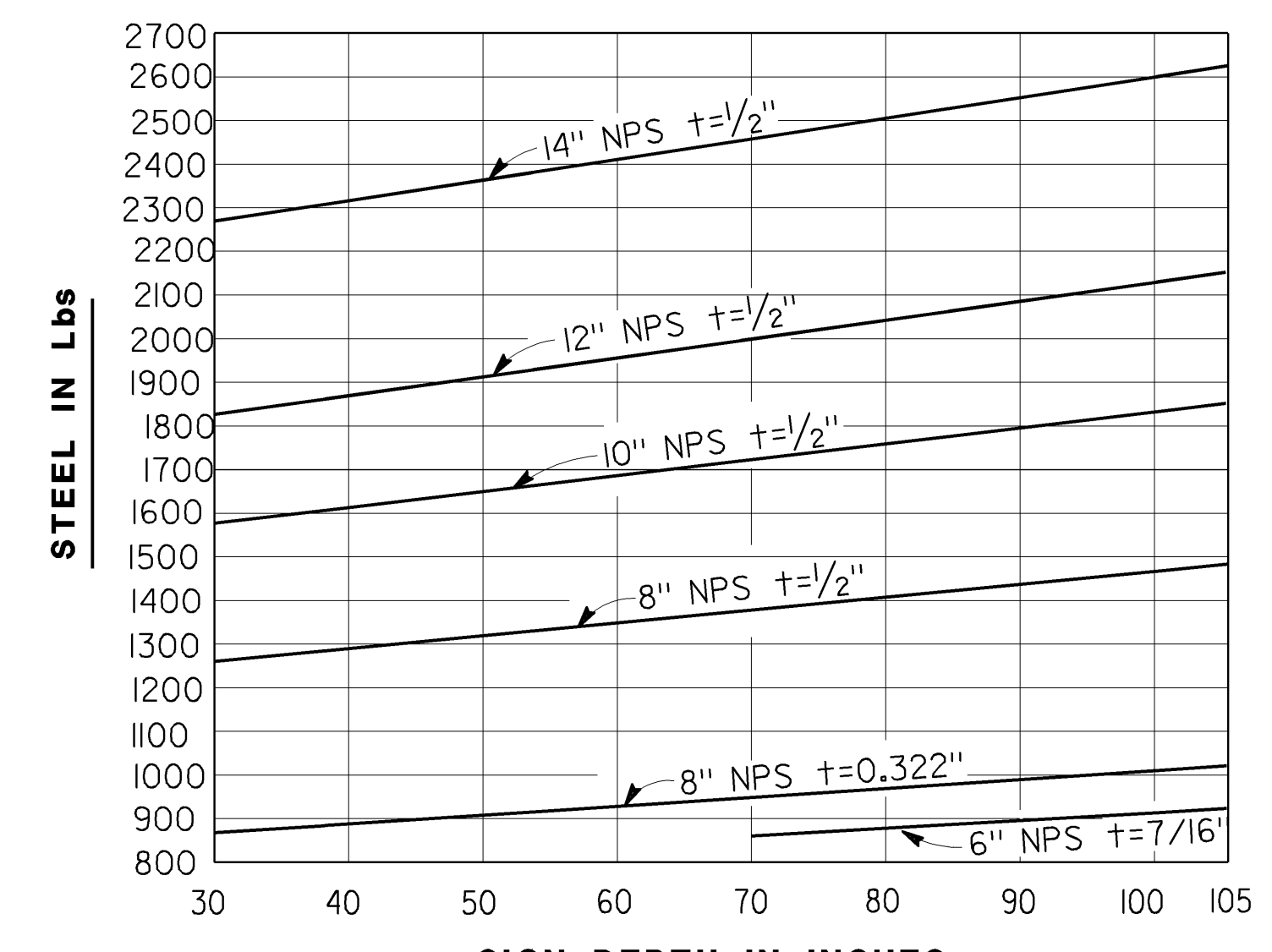

POST QUANTITIES - TYPE B-2

NOTES:

- See Page 22, 23, and 24 for definitions and sizing of post, cross beams, and mast arms on Types A, B, and C.
- Cross beam and Mast arm quantities include structural tubings, angles, plates and truss.
- Post quantities include pipes, post angles, plates, base plate and anchor bolt assemblies.
- Values are figured for "h" = 18'-0". For "h" greater or less than 18'-0" add or subtract Lb/ft of post from values shown on "POST QUANTITIES" charts.

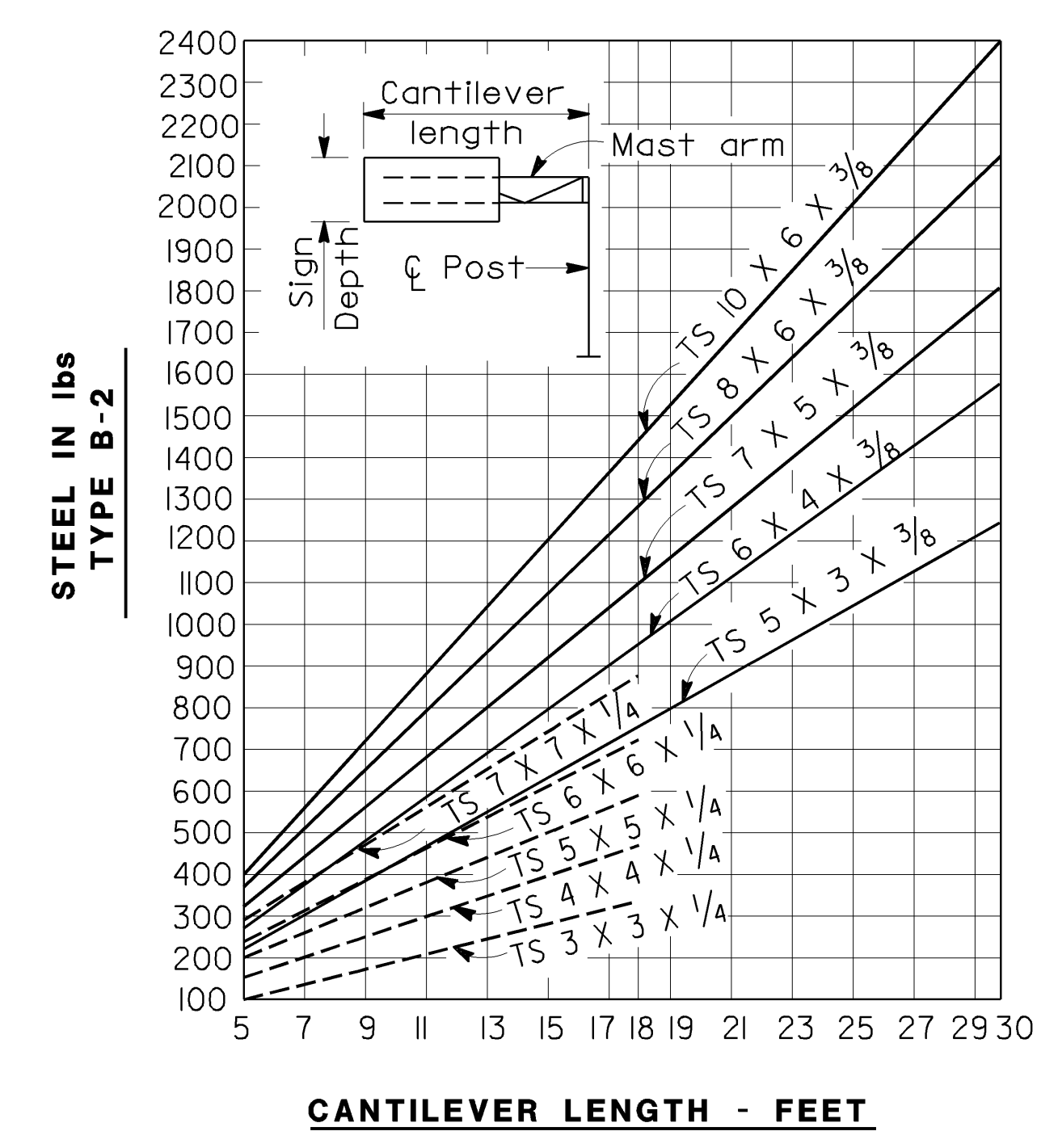

MAST ARM QUANTITIES - TYPE C

NOTE: Indicates Type C-1 -----
Indicates Type C-2 _____

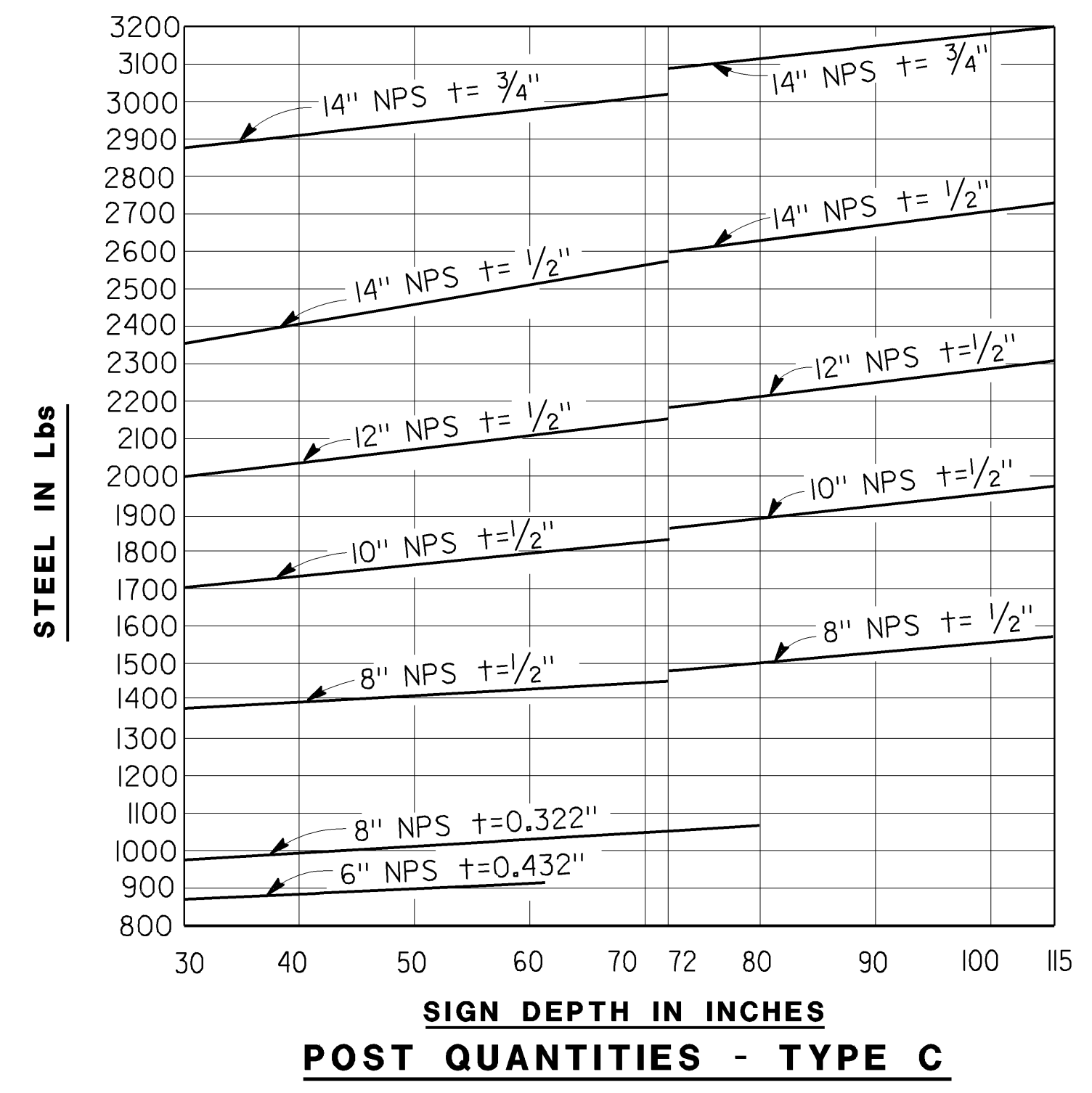

POST QUANTITIES - TYPE C